

MEIGSVILLE TOWNSHIP SECTION 29 R11 TWP 10 MORGAN COUNTY, OHIO

PIN	Owner	VOL	PAG	LegalDescr	Acres	Survey_Ref
120-000-640-0	CALENDINE ROGER H & JANETTE K	D.V	183 293	R11 T10 S29 SD 67	15.569	MIG-0098.pdf
120-005-880-0	CHOI JUNG Y & YUHE	D.V	202 56	R11 T10 S29 SD 64	7.5	NoSurvey.pdf
120-005-850-0	CHOI JUNG Y & YUHE	D.V	202 56	R11 T10 S29 SD 56	31	NoSurvey.pdf
120-005-870-0	CHOI JUNG Y & YUHE	D.V	202 56	R11 T10 S29 SD 63	7	NoSurvey.pdf
120-005-860-0	CHOI JUNG Y & YUHE	D.V	202 56	R11 T10 S29 SD 62	7	NoSurvey.pdf
120-003-180-0	HANSON CLAY W & MARY PAT	OR190	462	R11 T10 S29 SD 51	61.886	MIG-0380.pdf
120-003-020-0	SCHUMACHER FAMILY FARM LLC	OR221	3236	R11 T10 S29 SD 59	86.215	MIG-0295.pdf
120-008-580-0	STEPHENS ANDREA & JESSICA ISALY	OR31	699	R11 T10 S29 SD 50	66.601	NoSurvey.pdf
120-000-310-0	WELLS MICHAEL & KELLY	OR233	3161	R11 T10 S29 SD 65	0.83	MIG-0020.pdf
120-007-570-0	WILLIAMS REX F & MICHELLE R REV T	OR227	1696	R11 T10 S29 SD 52	54.48	MIG-0275.pdf

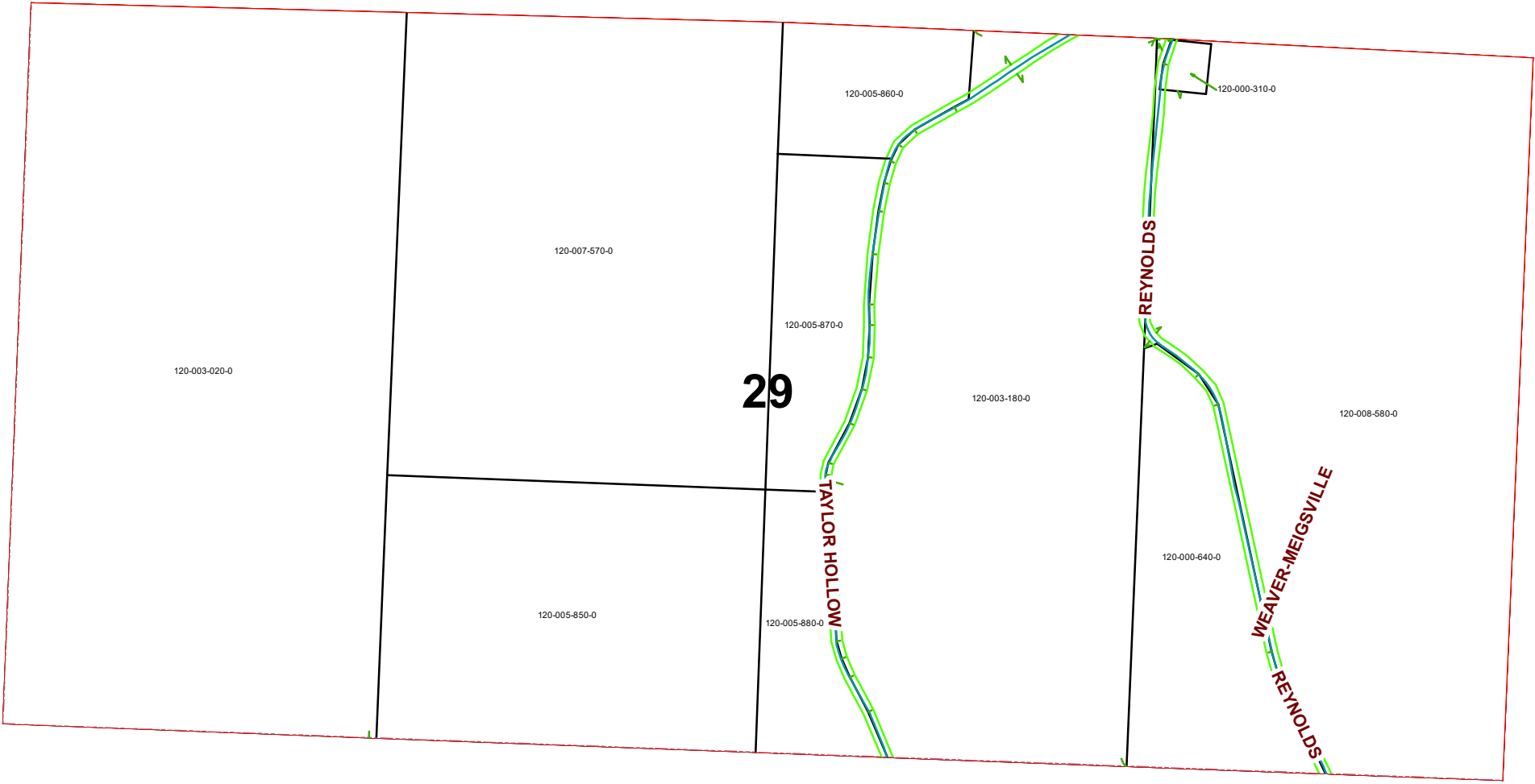

Boundaries			
	Hydro		Section
	Roads		Lot
	County		Parcel
	Township		ROW

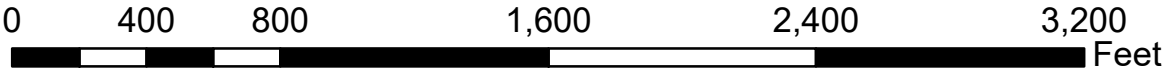

Disclaimer: The information that these maps contains is for reference purposes only. Please bring any erros to the attention of the Engineer's Office staff. Thank you